

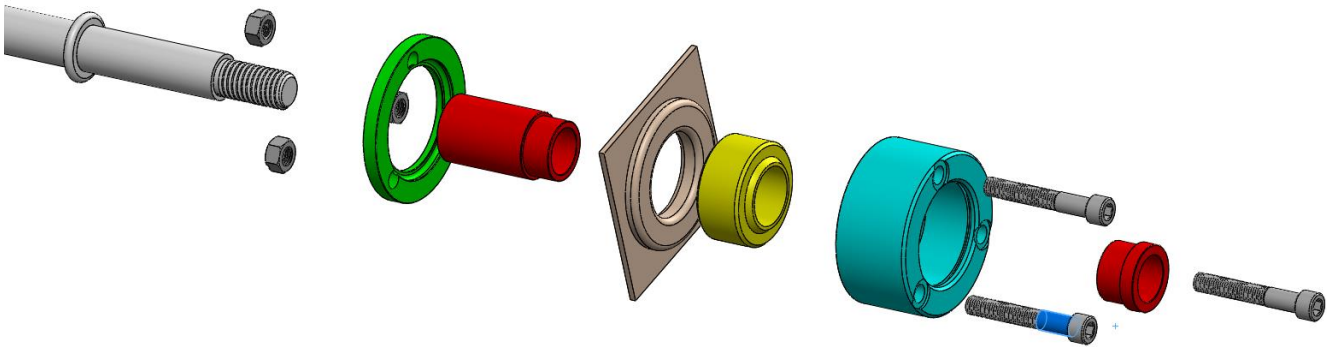

Strut Isolators for Ford Cards



- 72-76 Gran Torino
- 72-76 Mercury Montego
- 74-79 Mercury Cougar
- 74-76 Ford Elite
- 72-79 Ranchero
- 76-79 Thunderbird
- 76-79 LTDII
- 65-up Galaxie and other full size Fords

- It is the buyer's responsibility to check proper clearance and function of all parts to their existing suspension components and wheels/tires before driving the vehicle!
- For any questions or suggestions, email orders@littleshopmfg.com



1 & 2

Remove the factory strut rod from both the frame and the lower control arm. Insert the new bearing cup into the factory bushing hole. The 3 bolts can be oriented however you choose with respect to access under the core support. An angle finder can be used on any 2 of the bolts to match right and left sides.

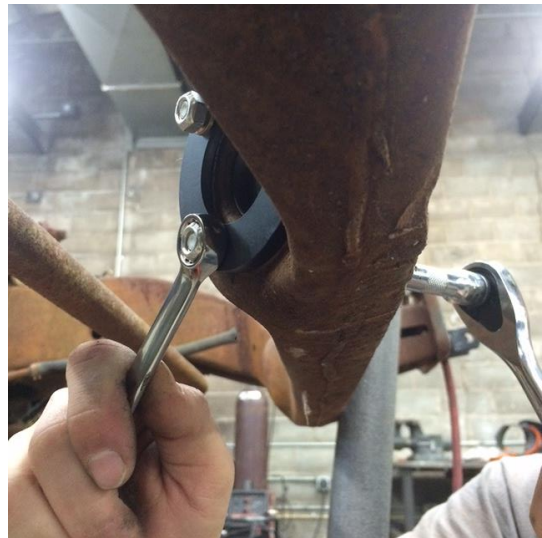

3 & 4

Drill through the frame with a 5/16 bit while clamping the bearing to the frame. The washer ring can now be bolted in using the supplied hardware.



5 & 6

Install the COM16T bearing by light tapping if necessary. Install the supplied snap ring to retain it.



7 & 8

Install the long misalignment spacer then insert the strut rod (without bushings) through the bearing side first, then reconnect to the lower control arm, leaving the hardware loose. The short misalignment spacer can then be tapped in on the front side.



9

Tighten the factory 5/8 nut back on until it seats. Finish tightening the lower control arm hardware.

